

Easy Mount Photoelectric Sensor

Back Ground Suppression Type

FXE-BGS



SALIENT FEATURES

- ◆ Distance Settable Type
- ◆ Back Ground Suppression
- ◆ IP-67, Shock Resistant - 100G
- ◆ M18 Threaded Front Mounting
- ◆ Light ON, Dark ON - Dual Output



Model Number Legend

FXE-BGS - -

1 2 3 4 5

1. Series

FXE

2. Type

BGS: Diffuse Back Ground Suppression Type

3. Sensing Distance

200: 200 mm

4. Output

ND: NPN - NO, NC Dual Output

PD: PNP - NO, NC Dual Output

5. Connection

2M: 2m Cable

M8C: M8 Connector

M12J3: M12 Junction Connector with 0.3m extension

#. Accessories included

Mounting Nut (M18): 1 No.

Mounting Screws : 1 Set

Example:

FXE-BGS-200PD-2M

FXE Series - Diffuse Back Ground Suppression Type - 200mm Sensing Distance, PNP NO, NC Dual Outputs - 2m Cable

NOTE: Contact us for models not shown in catalogue.
Connector cables are sold separately; look in CC series catalogue for the same (www.inno.sg/cc).

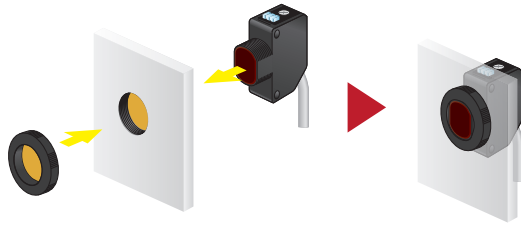

◆ M18 Threaded Mounting!

The FXE Series sensors can simply be mounted by inserting it into an M18 opening. The sensor head has a threaded surface and an M18 locking nut is provided. This makes mounting this unit Easy and Fast!

Conventional mounting holes are also provided in the sensor body for added flexibility.

◆ BGS Sensing

The FXE-BGS sensors are distance settable and have Back Ground Suppression and the sensing is not influenced by Color or Texture of the sensing object. The same applies for the color changes in the background.

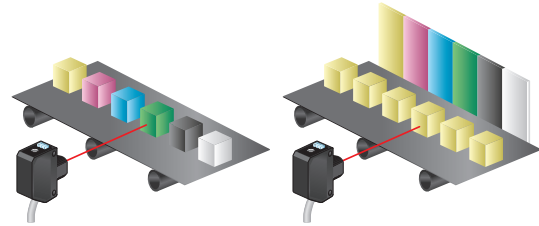

Ratings and Specifications

Type		Diffuse Reflective		
Models	NPN	FXE-BGS-200ND-2M	FXE-BGS-200ND-M8C	FXE-BGS-200ND-M12J3
	PNP	FXE-BGS-200PD-2M	FXE-BGS-200PD-M8C	FXE-BGS-200PD-M12J3
Sensing Distance		0 ~ 200mm		
Setting Distance		30 ~ 200mm		
Spot Size		Ø 15mm at 200mm		
Hysteresis		5%		
Response Time		500 µ Sec		
Sensitivity Adjustment		Built-in externally adjustable 4 turn endless pot.		
Operation Mode		Light ON and Dark ON outputs provided		
Supply Voltage		10 - 30 VDC (Ripple Max 10%)		
Current Consumption		max. 30mA		
Protection Circuits		Reverse Polarity, Transient Voltages, Output Overcurrent indication		
Connection		Prewired 2 meter cable outgoing type	M8 Connector type	M12 Jn. Connector, 0.3m extension
Control Output		NO, NC - NPN or PNP open collector output (depending on model)		
Control Output Rating		Load Voltage: max. 30 VDC; Load Current: max 100mA		
Operation Indication		GREEN: Stable; YELLOW: Output ON; RED: Alarm - Overload		
Shock Resistance		100 G- X,Y, Z three directions		
Environmental Illuminance		Sunlight: 10,000 lux, Lamp: 3,000 lux		
Ambient Temperature		Operation: -25° ~ 55°C; Storage: -40° ~ 70°C (non- freezing, non- condensing)		
Ambient Humidity		Operation: 35 ~ 85% RH; Storage: 35 ~ 90% RH (non- condensing)		
Protection Class		IP67		
Weight		approx. 10g without cable		
Material		Housing: ABS with Glass, Lens: PMMA or Eqv.		

Product Highlights

FXE-BGS

◆ Rugged & Waterproof

The sensor has an IP67 construction making it suitable for use in places where it may be exposed to water spray.

The sensor has a rigid design and superior construction for high resistance to mechanical shocks upto 100G.

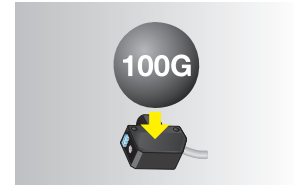

Proximity Sensors

Photoelectric Sensors

Measurement Sensors

Vision & Safety Sensors

Sensor Dimension Drawing

Outgoing Cable Type & M12 Junction Connector Type

- ◆ FXE-BGS-200ND-2M
- ◆ FXE-BGS-200PD-2M
- ◆ FXE-BGS-200ND-M12J3
- ◆ FXE-BGS-200PD-M12J3

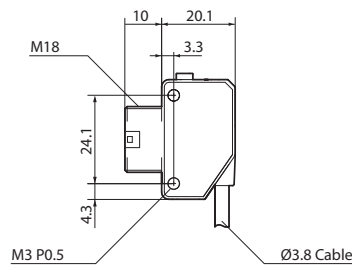
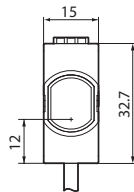

Connector Type

- ◆ FXE-BGS-200ND-M8C
- ◆ FXE-BGS-200PD-M8C

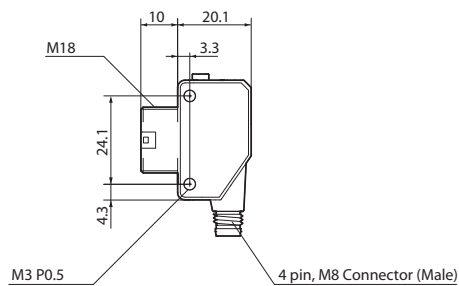
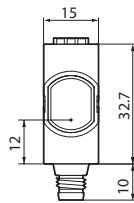

Locking Nut

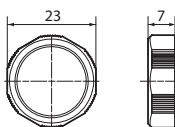

M18- 1 Nut

M12 Junction Connector

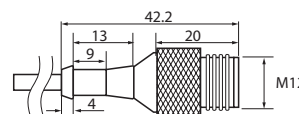

All dimensions are in mm

Control

Weighing

Automation

Components

Connection

• Cable

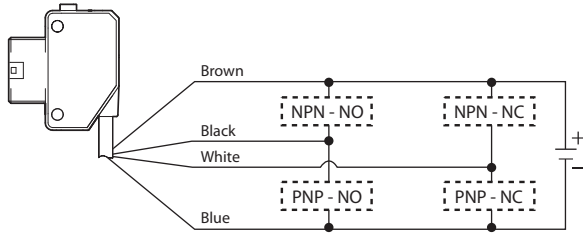

- Brown : DC 10~30V
- Blue : 0V
- Black : Control Output (Light ON)
- White : Control Output (Dark ON)

• M8 Connector *

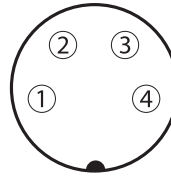

- 1 : DC 10~30V
- 2 : Control Output (Dark ON)
- 3 : 0V
- 4 : Control Output (Light ON)

• M12 Junction Connector *

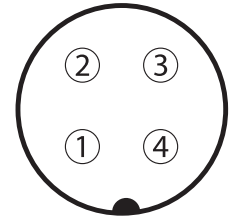

Note: * - Connector Cable is not supplied along with unit

Control Output Diagram

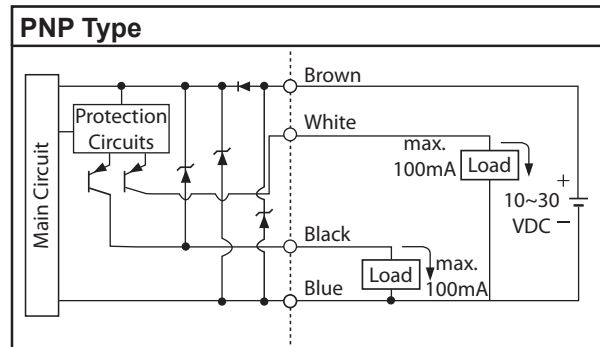
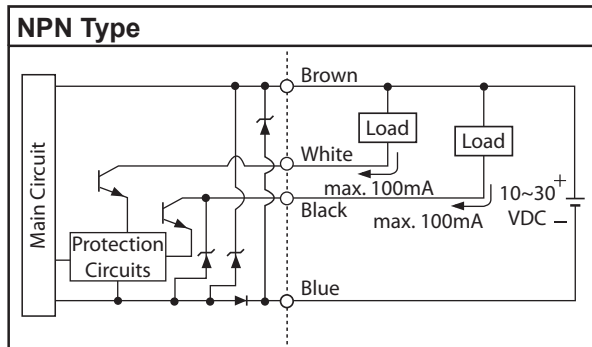

Brown: DC 10~30V; Blue: 0V; Black: Control Output (Light ON); White: Control Output (Dark ON)

Operation Type

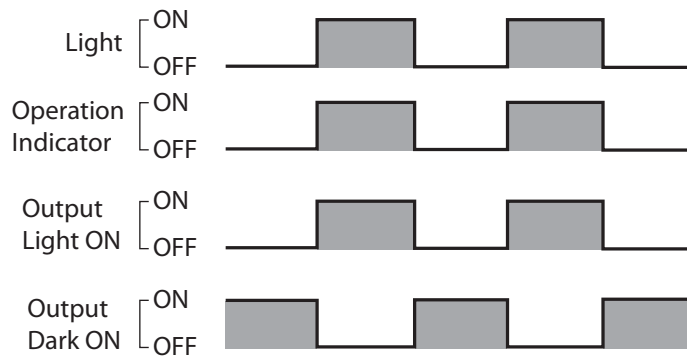

Nomenclature

FXE-BGS

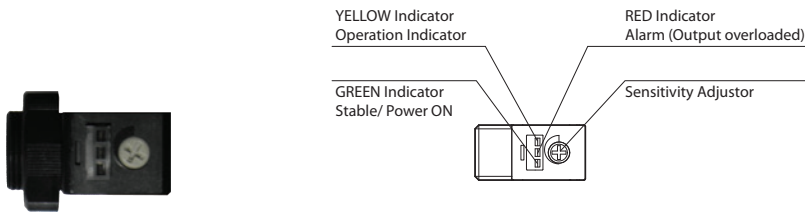

Operational Data

Parallel Shifting Characteristic

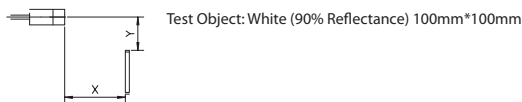
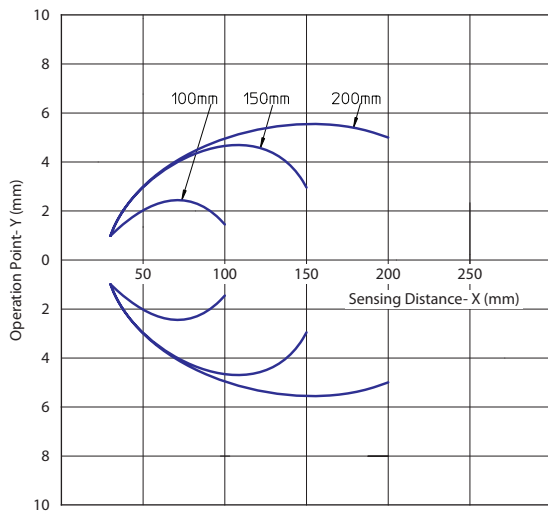

Hysteresis

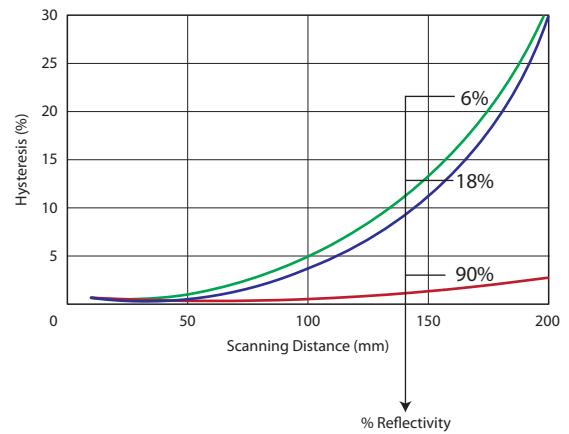

Spot Size

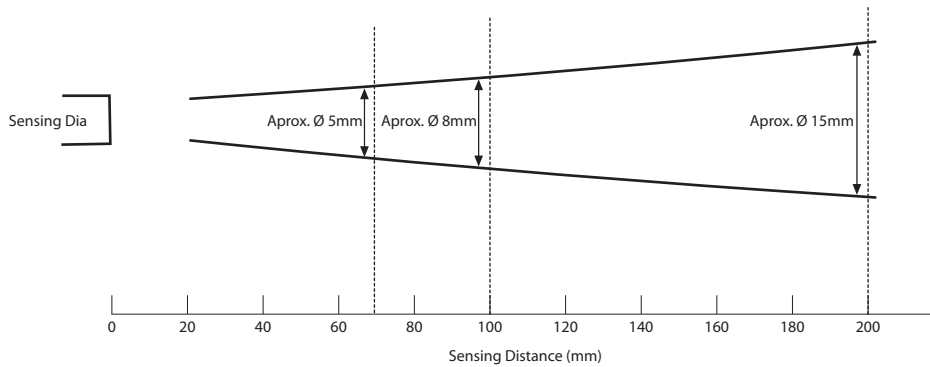

Operation Mode Adjustment

FXE-BGS

The FXE-BGS sensors come with a dual output. Hence the need for selection between Light ON/ Dark ON models is eliminated.
 The wire Black carries the Output NO/ Light ON.
 The wire White carries the Output NC/ Dark ON.

Sensitivity Adjustment

	<p>The adjuster is to be rotated in the clockwise direction to increase the sensitivity and thereby the sensing distance.</p>
	<p>The adjuster is to be rotated in the anti-clockwise direction to decrease the sensitivity and thereby the sensing distance.</p>

Note: The adjuster is a 4- turn endless pot

Mounting

Sensor can be mounted on an M18 cutout. The locking nut holds the unit in position.

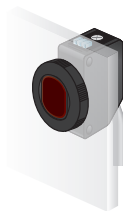

Sensor can be mounted on bracket. Screw size M3 is to be used for mounting of sensor to the bracket*.

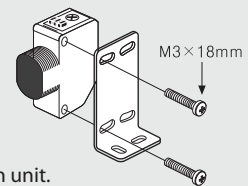

*: Bracket is not supplied along with unit.

Exclusively Represented by:

Intech Systems Chennai Pvt Ltd
 S-2, Guindy Industrial Estate
 Chennai - 600 032. Ph: 4353 8888
 Email: info@intechchennai.com

innoTM
www.inno.sg

© INNO, Rights Reserved
 In the interest of continuous product improvement
 specifications are subject to change without notice

Cat. No. FXE-BGS-512

www.inno.sg/fxe-bgs