



Cat. No. FXE-512

FXE EASY MOUNT PHOTOELECTRIC SENSOR



INSTRUCTION SHEET

Thank you for selecting INNO for your requirement.

This sheet describes the procedure and precautions required for installing and operating the product.

Kindly read this sheet before operating or installing the product. Store the sheet for future reference.

CAUTION FOR SAFETY

- ⓘ Please keep this sheet for review before use of unit.
- ⓘ Please observe the following:

⚠ WARNING
Serious injury may occur if instructions are not followed

⚠ CAUTION
Product failure or injury can occur if instructions are not followed

⚠ WARNING

- This is not a safety product and is not to be used with machinery that requires use of safety control.
- Do not disassemble or modify this unit. It may lead to electric shock/ fire.

Do not connect sensor to AC power supply.
RISK OF EXPLOSION!



⚠ CAUTION

- This unit shall not be used outdoors.
- Do not use the unit in places where there is flammable or explosive gas.
- Please observe the rated specifications in Instruction Sheet.
- Do not use this unit beyond rated power and do not supply AC power at DC power type; do not connect without load.
- Please check the polarity of power and wrong wiring.
- Do not use this unit in places where there is vibration or impact.
- Do not use water or oil based detergent for cleaning the unit.
- Do not use excessive force to tighten the unit and do not hammer the unit.
- Please process it as industrial waste and dispose responsibly.

▴ SPECIFICATIONS

*For details on Customized/ Special Models contact Seller

Type	Through Beam		Retro-Reflective		Diffuse Reflective		
Output Type	NPN	PNP	NPN	PNP	NPN	PNP	
*Models	Cable	FXE-T-30MND-2M	FXE-T-30MPD-2M	FXE-R-3.5MND-2M	FXE-R-3.5MPD-2M	FXE-D-400ND-2M	FXE-D-400PD-2M
	Connector	FXE-T-30MND-M8C	FXE-T-30MPD-M8C	FXE-R-3.5MND-M8C	FXE-R-3.5MPD-M8C	FXE-D-400ND-M8C	FXE-D-400PD-M8C
	Junction Connector	FXE-T-30MND-M12J3	FXE-T-30MPD-M12J3	FXE-R-3.5MND-M12J3	FXE-R-3.5MPD-M12J3	FXE-D-400ND-M12J3	FXE-D-400PD-M12J3
Sensing Distance	30 Meters		3.5 Meters		400 mm		
Light Source	Red LED						
Hysteresis	-					20% max.	
Spot Size	Ø 610mm/ 30 m		Ø 75mm/ 3.5 m		Ø 12mm/ 400mm		
Response Time	500 µ Sec						
Sensitivity Adjustment	Built-in externally adjustable 1 turn pot.						
Operation Mode	Light ON and Dark ON outputs provided						
Supply Voltage	10 - 30 VDC (Ripple Max 10%)						
Current Consumption	Emitter: max. 15mA; Receiver: max. 20mA			max. 30mA			
Protection Circuits	Reverse Polarity, Transient Voltages, Output Overcurrent indication						
Control Output	NO, NC - NPN or PNP open collector output (depending on model)						
Control Output Rating	Load Voltage: max. 30 VDC; Load Current: max 100mA						
Operation Indication	GREEN: Stable; YELLOW: Output ON; RED: Alarm - Overload / Through Beam Emitter Green Only						
Shock Resistance	100 G - X,Y, Z three directions						
Environmental Illuminance	Sunlight: 10,000 lux, Lamp: 3,000 lux						
Ambient Temperature	Operation: -25° ~ 55°C; Storage: -40° ~ 70°C (non- freezing; non- condensing)						
Ambient Humidity	Operation: 35 ~ 85% RH; Storage: 35 ~ 90% RH (non- condensing)						
Protection Class	IP67						
Weight	approx. 10g without cable						
Material	Housing: ABS with Glass, Lens: PMMA or Eqv.						

▴ DIMENSIONS

• Cable and Junction Connector Type

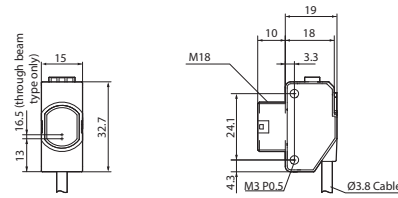

• Reflector V-61

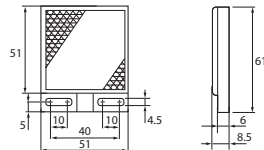

• Locking Nut

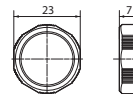

• Connector Type

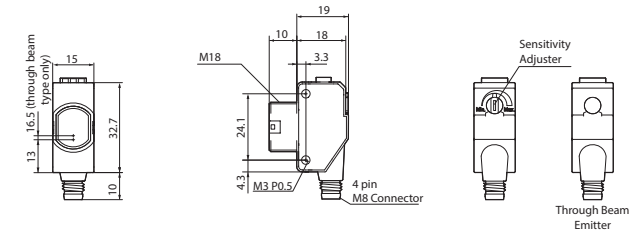

M18- 1 Nut

Represented by:

Intech Systems Chennai Pvt. Ltd.
S-2, Guindy Industrial Estate
Chennai - 32. Ph: 044 4353 8888
Email: info@intechchennai.com



© Rights Reserved

OUTPUT CIRCUIT DIAGRAM

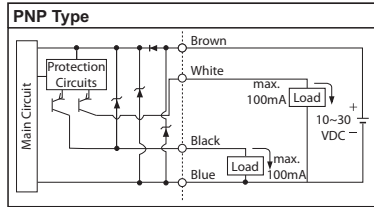
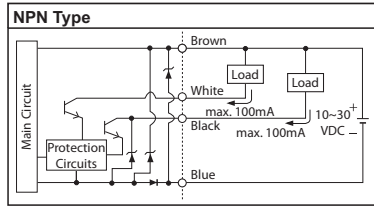

NOMENCLATURE

Through Beam Receiver, Retro-reflective, Diffuse

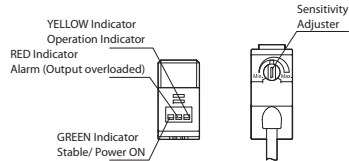

CONNECTION DIAGRAM

Cable Type

Through Beam

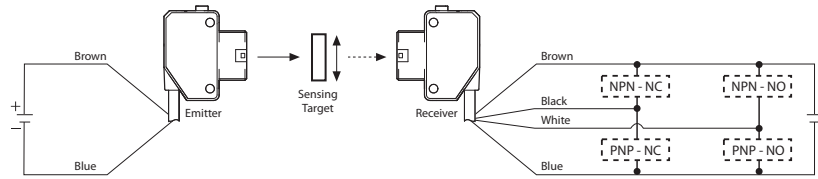

LEGEND:

- Brown : DC 10~30V
- Blue : 0 V
- Black : Light ON Output
- White : Dark ON Output

Through Beam Emitter

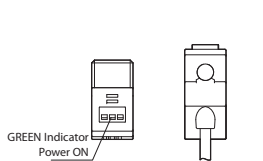

Represented by:

Intech Systems Chennai Pvt. Ltd.
S-2, Guindy Industrial Estate
Chennai - 32. Ph: 044 4353 8888
Email: info@intechchennai.com

innob
www.inno.sg

© Rights Reserved

MOUNTING AND ADJUSTMENTS

Mounting

M18 mounting shown in Fig (a).
Tightening torque 0.3 NM



To mount the sensor to a bracket as shown in Fig (b), use M3 screws.
Tightening torque 0.6 Nm

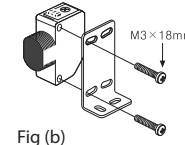

Sensitivity Adjustment



The adjuster is to be rotated in the clockwise direction to increase the sensitivity and anti-clockwise direction to decrease the sensitivity. The adjuster is a 1 turn pot, rotating beyond a single turn can cause the sensor to fail.

M8 Connector

M12 Junction Connector

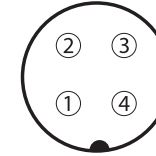
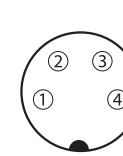

LEGEND:

- 1 : DC 10~30V
 - 2 : Dark ON Output
 - 3 : 0 V
 - 4 : Light ON Output
- Note: Connector Cable is not supplied with unit

INTENTIONALLY LEFT EMPTY