

Miniature Box Computer

IPC-B



SALIENT FEATURES

- ◆ Fanless
- ◆ Atom N270
- ◆ 1- LAN, 4 USB
- ◆ DVI Video Output
- ◆ Mini- PCIe Card Slot
- ◆ 1- RS232/422/485 Port
- ◆ 1- CF Slot, 2.5" SATA HDD

Model Number Legend

IPC-B - -

1 2 3 4 5

1. Series

IPC

2. Type

B: B Type with Intel Atom N270

3. RAM

1: 1GB DDR 2

2: 2GB DDR 2

4. Hard Disc Capacity

CF: 32GB CF Card

25: 250GB SATA

50: 500GB SATA

5. Operating System

DOS: Free DOS

WXP: Windows XP Professional 32-bit

#. Accessories

Screws & Mounting Clamps : 1 Set

DVI to VGA Converter : 1 No.

Power Plug Adapter : 1 No.

Example:

IPC-B-250-WXP

IPC Series - B Type with Intel Atom N270 - 2GB DDR2 RAM, 500GB SATA HDD - Windows XP Professional 32-bit OS

NOTE: Contact us for models not shown in catalogue.

◆ Fanless Design

Industrial grade fanless design in a compact housing. High grade thermal compounds and finned aluminium body allow for efficient heat dissipation.

◆ CF Slot

Compact Flash card is provided by default in all variants and is easily accessible by opening the front panel of the PC. The slot can accept upto 64 GB Compact flash memory cards.

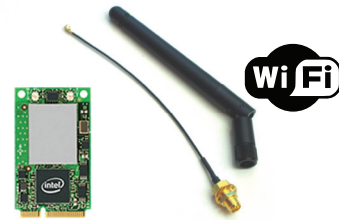

◆ Optional Wireless

1 Mini PCIe slot is provided for adding a wireless lan. The slot can also be utilised to add any other compatible card like Input Cards.

Ratings and Specifications

Storage Capacity		32 GB	250 GB	500 GB	
Models		IPC-B- _ CF- _	IPC-B- _ 25- _	IPC-B- _ 50- _	
System	Motherboard	Intel 945GSE+ 8280GBM(ICH7M) chipset Micro-ATX Split board			
	CPU	Intel Atom N270 1.6GHz low-power CPU, 1MB L2 cache			
	RAM	1GB/ 2GB DDR2-533MHz (depending on model)			
	Network	2x Intel 82574L Gigabit Lan			
	HDD	32GB CF or 250GB/ 500GB 2.5" SATA Hard disc at 5400RPM			
	GPU	Integerated Intel GMA 3150, 256MB shared			
	Ports	COM	1 9pin Serial Male (RS-232/ 422/ 485)		
		PS/2	1 Combo		
		VIDEO	1 DVI-I Connector		
		USB	4 USB V2.0		
LAN		1 Gigabit LAN (RJ-45) - Realtek RTL8111C			
Expansion	Audio	1 - Mic, Line-in, Line-out			
	Storage Bay	1 - 2.5" SATA HDD Space, 1 - Compact Flash Card Type I / II socket			
Power Supply		12-24VDC ±10%; max. - 2 pin conenctor/ Jack			
Current Consumption		0.86A typical; 1.65A max. at 19VDC			
Indications		2 Power LEDs, 1 HDD LED, 2 LAN LEDs			
Operating Temperature		-10° ~ 40°C(non- freezing; non- condensing)			
Storage Temperature		-20° ~ 60°C (non- freezing; non- condensing)			
Operating Humidity		30 ~ 80% RH (non- condensing)			
Storage Humidity		5 ~ 95% RH (non- condensing)			
Vibration		5-17Hz/1mm amplitude in all three directions, X, Y, Z			
Shock		10G			
Protection Class		Front Panel: IP65			
MTBF		>10,000 hours			
Weight		Aprox. 825g			
Material		Cast Aluminium Alloy			

Component Names and Function

IPC-B

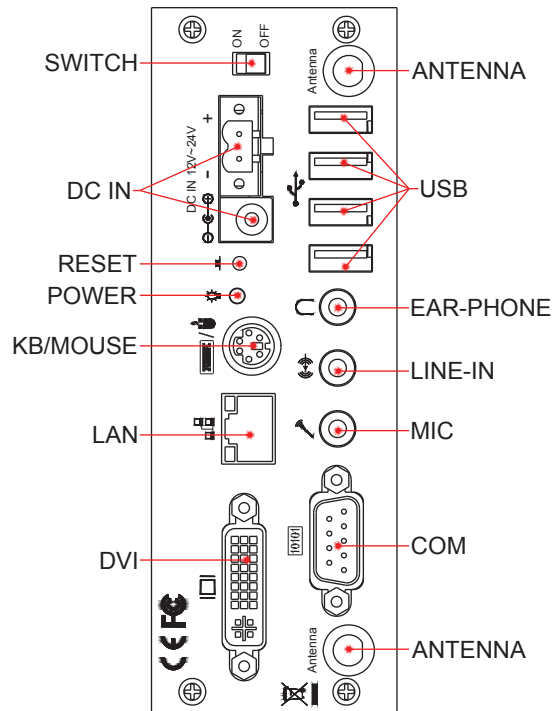

Optional Part

◆ STORAGE

32GB Compact Flash Memory	IPC-B-ACF
64GB Solid State SATA Memory	IPC-B-A64SSD
128GB Solid State SATA Memory	IPC-B-A128SSD
250GB 2.5" SATA HDD 5400RPM	IPC-B-A250HDD
500GB 2.5" SATA HDD 5400RPM	IPC-B-A500HDD

◆ RAM

1GB DDR2 533 Kingston RAM Module	IPC-B-A1RAM
2GB DDR2 533 Kingston RAM Module	IPC-B-A2RAM

◆ POWER SUPPLY

24VDC, 2A SMPS with Power Jack	IPC-B-ASMPSJ
--------------------------------	--------------

◆ OTHER

DVI-I to VGA convertor	IPC-B-AVGA
------------------------	------------

Sensing

Control

Weighing

HMI's

PLCs

Remote I/O Modules

Industrial Computers

Components

- Sensing
- Control
- Weighing
- HMI's
- PLCs
- Remote I/O Modules
- Industrial Computers

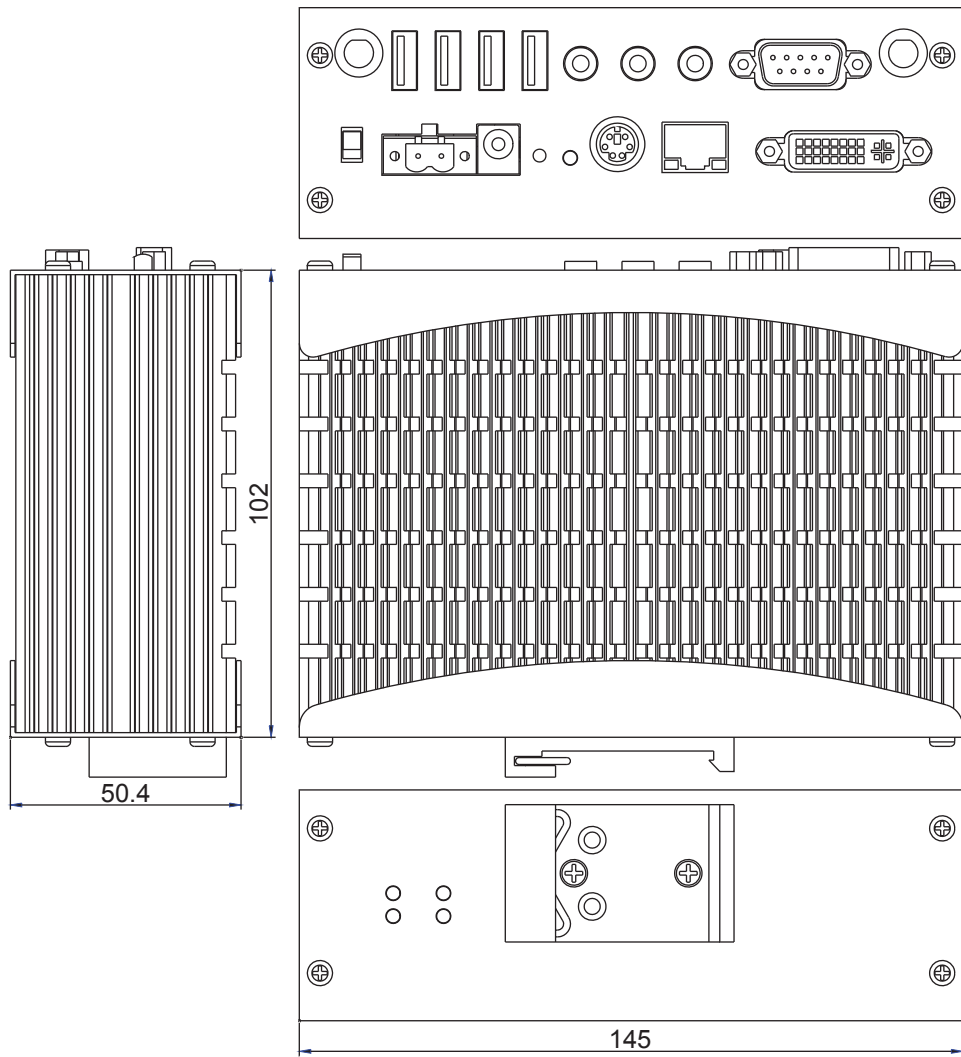

All dimensions are in mm

Exclusively Represented by:

Intech Systems Chennai Pvt Ltd
 S-2, Guindy Industrial Estate
 Chennai - 600 032. Ph: 4353 8888
 Email: info@intechchennai.com

innoTM
www.inno.sg

© INNO, Rights Reserved
 In the interest of continuous product improvement
 specifications are subject to change without notice

Cat. No. IPC-B-413

www.inno.sg/ipc-b

- Components