

# High Temperature Proximity Sensor

Works upto 110 °C !

# PQH

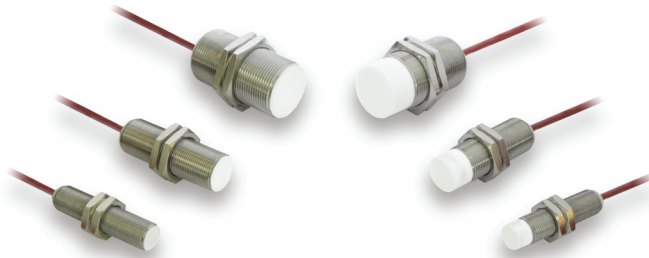

## SALIENT FEATURES

- ◆ SS Housing
- ◆ Silicone Cable
- ◆ Detergent Resistant
- ◆ LED- Status Indication
- ◆ M12, M18 & M30 Models
- ◆ Shielded and Non - Shielded
- ◆ Improved IC for Noise Resistance

## Model Number Legend



**PQH**-    -    -    
**1**    **2 3**    **4 5**    **6**

### 1. Series

PQH

### 2. Housing

M12: M12, Threaded

M18: M18, Threaded

M30: M30, Threaded

### 3. Shield

F: Flush/ Shielded

N: Non-Flush/ Unshielded

### 4. Sensing Distance

2: 2 mm

4: 4 mm

5: 5 mm

8: 8 mm

10: 10 mm

15: 15 mm

### 5. Output

NO: NPN - NO

PO: PNP - NO

### 6. Connection

2M: 2m Cable

### #. Accessories included

Check Nut: 1 Pair

### Example:

PQH-M18N-8NO-2M

PQH Series - M18, Non-Flush - 8mm Sensing Distance, NPN NO - 2 meter Silicone Cable

**NOTE:** Contact us for models not shown in catalogue.

## Product Highlights

### ◆ Works upto 110°C

The PQH series realizes the industry demand for an affordable high temperature inductive sensor.

The teflon coated PTFE top and the SS tube makes the sensor resistant to temperatures of upto 110°C and suitable for use in food and pharma applications.

### ◆ High temperature Silicone cable

Most high temperature proximity manufacturers use a PUR cable for the sensor which cannot withstand high temperatures. This results in sensor cable failure or degradation.

To counter this PQH series includes a Silicone cable that is suitable for environments upto 120°C!

## Ratings and Specifications

Size			M12	M18	M30
Model	Flush	NPN - NO	PQH-M12F-2NO-2M	PQH-M18F-5NO-2M	PQH-M30F-10NO-2M
		PNP - NO	PQH-M12F-2PO-2M	PQH-M18F-5PO-2M	PQH-M30F-10PO-2M
	Non- Flush	NPN - NO	PQH-M12N-4NO-2M	PQH-M18N-8NO-2M	PQH-M30N-15NO-2M
		PNP - NO	PQH-M12N-4PO-2M	PQH-M18N-8PO-2M	PQH-M30N-15PO-2M
Sensing Distance	Flush		2mm	5mm	10mm
	Non- Flush		4mm	8mm	15mm
Standard Sensing Target			Iron, Ø12x1mm	Iron, Ø18x1mm	Iron, Ø30x1mm
Hysteresis			± 15%		
Response Frequency/ Time	Flush		2000 Hz/ 0.1ms	1000 Hz/ 0.2ms	300 Hz/ 0.5ms
	Non- Flush		1000 Hz/ 0.2ms	500 Hz/ 0.5ms	150 Hz/ 1ms
Supply Voltage			10-30VDC (ripple included)		
Current Consumption			< 10mA		
Output	Type		NPN or PNP - NO depending on the model		
	Switching Capacity		100mA; Overload trip: 120mA		
	Leakage Current		< 0.01mA		
	Voltage Drop		< 1.5VDC		
Indication			Output On: Red LED		
Protection Circuits			Reverse supply polarity; reversed output polarity; Short circuit; Overload protection		
Dielectric Strength			1000 VAC, 50/60 Hz for 1 minute between current carry parts and case		
Voltage Influence			± 5% max. of sensing distance (ref. sensing distance taken at 24VDC)		
Temperature Influence			± 15% max. of sensing distance (ref. sensing distance taken at 25°C)		
Vibration Resistance			10 - 55Hz, 1mm for 2 hours in X, Y, Z directions (destruction)		
Shock Resistance			50 G (10 times) in X, Y, Z direction for 3 times (destruction)		
Ambient Temperature			Operation: -25° ~ 110° C; Storage: -30° ~ 150° C (non-freezing; non-condensing)		
Ambient Humidity			Operation: 40 ~ 85% RH; Storage: 35 ~ 95% RH (non- condensing)		
Protection Class			IP-67		
Weight			approx. 60g	approx. 130g	approx. 215g
Cable			2M, 4Ø 3*0.25	2M, 5Ø 3*0.34	2M, 5Ø 3*0.34
Material			Head: Teflon; Tube: Stainless Steel; Nuts		
Tightening Torque			15 Nm (max.)	40 Nm (max.)	

# Sensor Dimension Drawing

PQH

Proximity Sensors

Photoelectric Sensors

Measurement Sensors

Vision & Safety Sensors

Control

Weighing

Automation

Components

PQH-M12F-2\_-2M

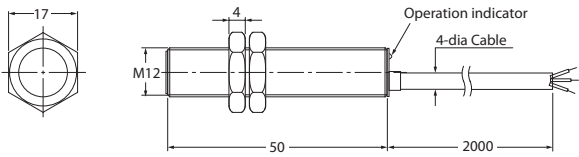

PQH-M12N-4\_-2M

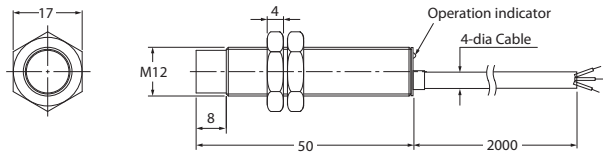

PQH-M18F-5\_-2M

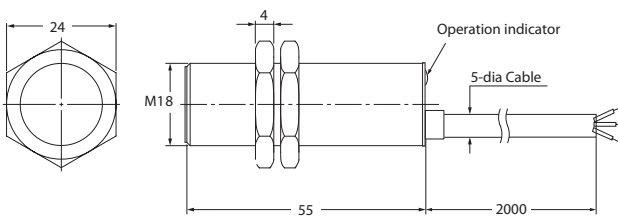

PQH-M18N-8\_-2M

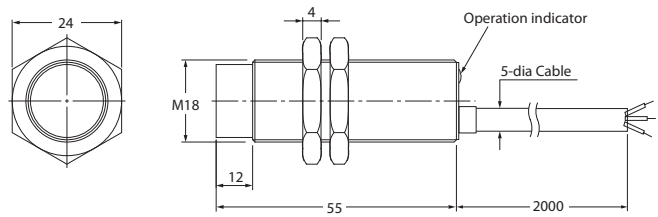

PQH-M30F-10\_-2M

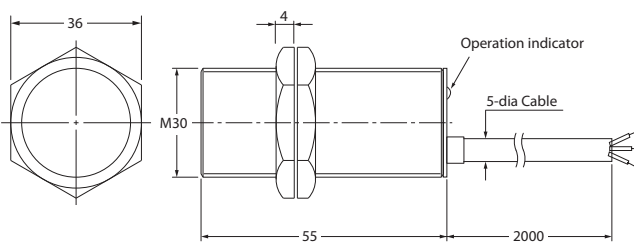

PQH-M30N-15\_-2M

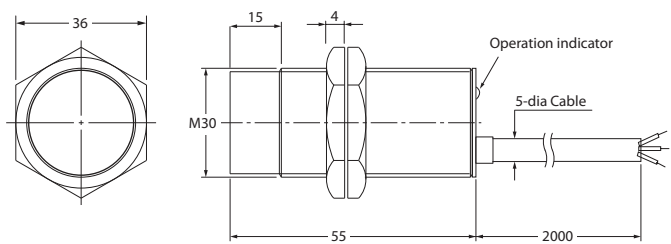

All dimensions are in mm

# Control Output Diagram

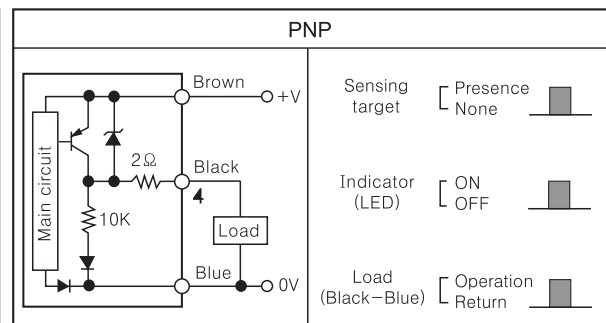
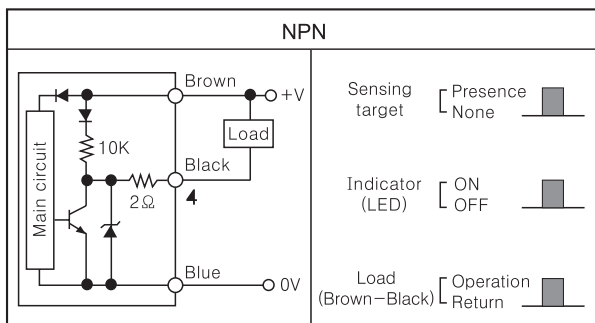

Brown : DC 10~30V  
 Blue : 0V  
 Black : Control Output

\*shown is for NO output

# Operational Range

## • Flush Type

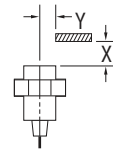
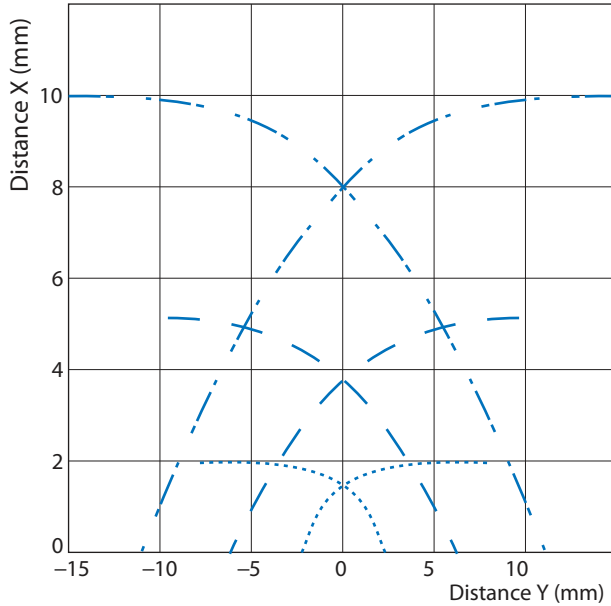

Note: Operational Range testing carried out at room temperature using standard Test Object.

- PQH-M12F-2\_-2M → [Dotted line]
- PQH-M18F-5\_-2M → [Dashed line]
- PQH-M30F-10\_-2M → [Dash-dot line]

## • Non-Flush Type

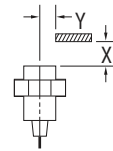
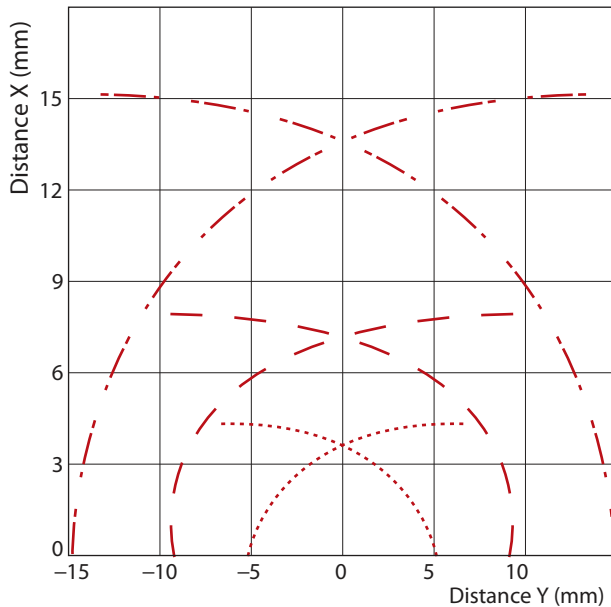

- PQH-M12N-4\_-2M → [Dotted line]
- PQH-M18N-8\_-2M → [Dashed line]
- PQH-M30N-15\_-2M → [Dash-dot line]

Exclusively Represented by:

Intech Systems Chennai Pvt Ltd  
 S-2, Guindy Industrial Estate  
 Chennai - 600 032. Ph: 4353 8888  
 Email: info@intechchennai.com

**inno**<sup>TM</sup>  
[www.inno.sg](http://www.inno.sg)

© INNO, Rights Reserved  
 In the interest of continuous product improvement  
 specifications are subject to change without notice

Cat. No. PQH-813