

- Fit the optional slit mask when the area sensor is used under the following conditions. However, note that the sensing range reduces when the slit mask is fitted.
  - In case mutual interference cannot be prevented by the interference prevention function alone, when using multiple area sensors (3 pcs. or more).
  - In case multiple area sensors are used and it is not possible to use the interference prevention function because of the wiring conditions of the equipment.
  - In case the operation is affected by extraneous lights such as rapid-starter or high frequency type of fluorescent lamps, other sensors, rotating lights, or sunlight.

### Slit mask for various NA40 series

Applicable beam channel No.	Model No.
4 channels	<b>OS-NA40-4</b>
6 channels	<b>OS-NA40-6</b>
8 channels	<b>OS-NA40-8</b>
10 channels	<b>OS-NA40-10</b>
12 channels	<b>OS-NA40-12</b>
14 channels	<b>OS-NA40-14</b>
16 channels	<b>OS-NA40-16</b>
20 channels	<b>OS-NA40-20</b>
24 channels	<b>OS-NA40-24</b>

Note: Take care that the above model Nos. represent one slit mask (not a pair).

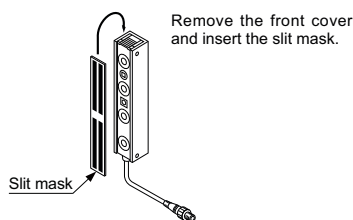

### Slit mask for various SF1 series

Applicable beam channel No.	Model No.
8 channels	<b>OS-SF1-8</b>
16 channels	<b>OS-SF1-16</b>
24 channels	<b>OS-SF1-24</b>
32 channels	<b>OS-SF1-32</b>
40 channels	<b>OS-SF1-40</b>
48 channels	<b>OS-SF1-48</b>
56 channels	<b>OS-SF1-56</b>
64 channels	<b>OS-SF1-64</b>

Note: Take care that the above model Nos. represent one slit mask (not a pair).

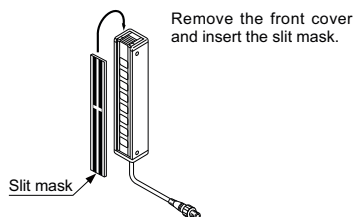

## Panasonic Electric Works SUNX Co., Ltd.

<http://panasonic-electric-works.net/sunx>

### Overseas Sales Division (Head Office)

2431-1 Ushiyama-cho, Kasugai-shi, Aichi, 486-0901, Japan Phone: +81-568-33-7861 FAX: +81-568-33-8591

### Europe Headquarter: Panasonic Electric Works Europe AG

Rudolf-Diesel-Ring 2, D-83607 Holzkirchen, Germany Phone: +49-8024-648-0

### US Headquarter: Panasonic Electric Works Corporation of America

629 Central Avenue New Providence, New Jersey 07974 USA Phone: +1-908-464-3550

PRINTED IN JAPAN

© Panasonic Electric Works SUNX Co., Ltd. 2011